

MOUNTING GRAPHIC

(P.1)

Infinity
SPACE

1. Open the snap profile near the end without any tools.

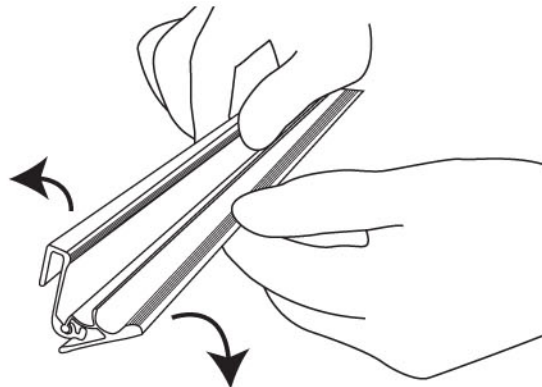
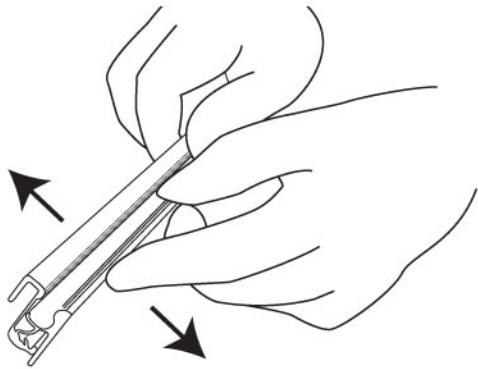

2. Insert the graphic into the profile and press hard.

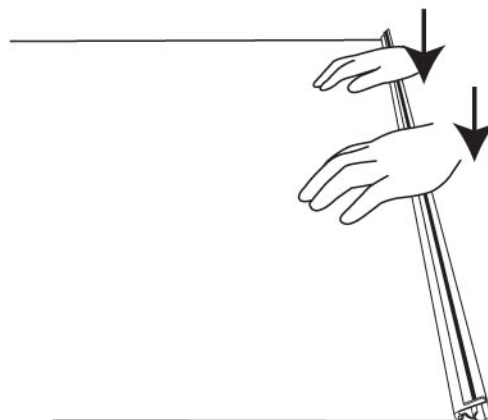
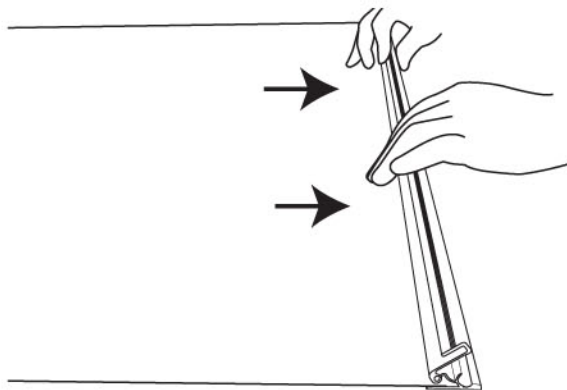

3. Open the cover by clicking the two black buttons at both ends.

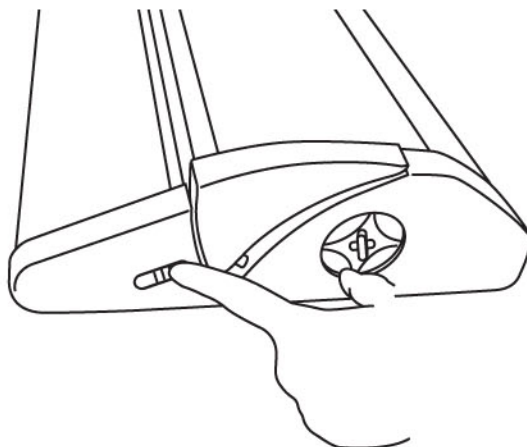

MOUNTING GRAPHIC

(P.2)

Infinity
SPACE

4. Insert the graphic into the snap roller inside the base, press hard along the entire roller until it's firm.

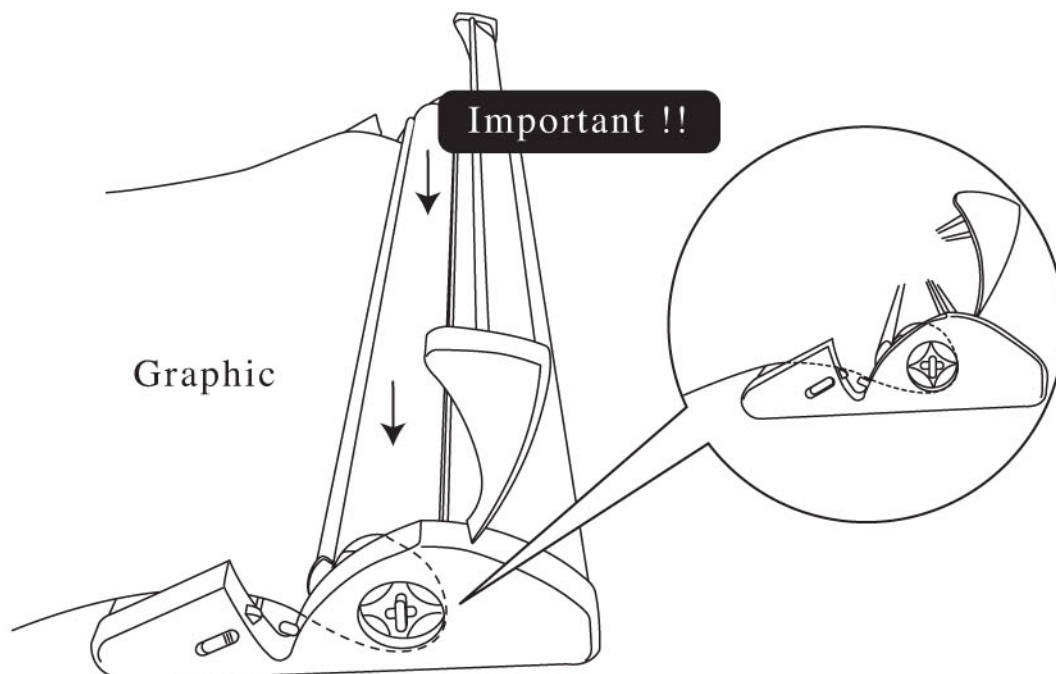

5. Let the entire graphic lay outside the base. Close the cover.

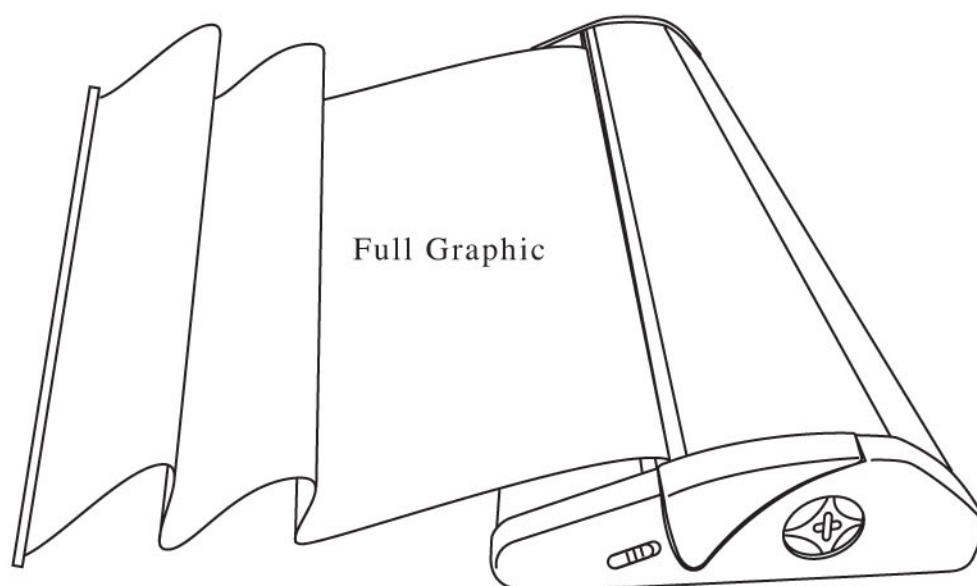

MOUNTING GRAPHIC

Infinity
SPACE

(P.3)

6. Turn the Red button on the locking device by 90° degree and push the graphic forward slightly to activate the spring system. Let the graphic retracts into the system slowly.

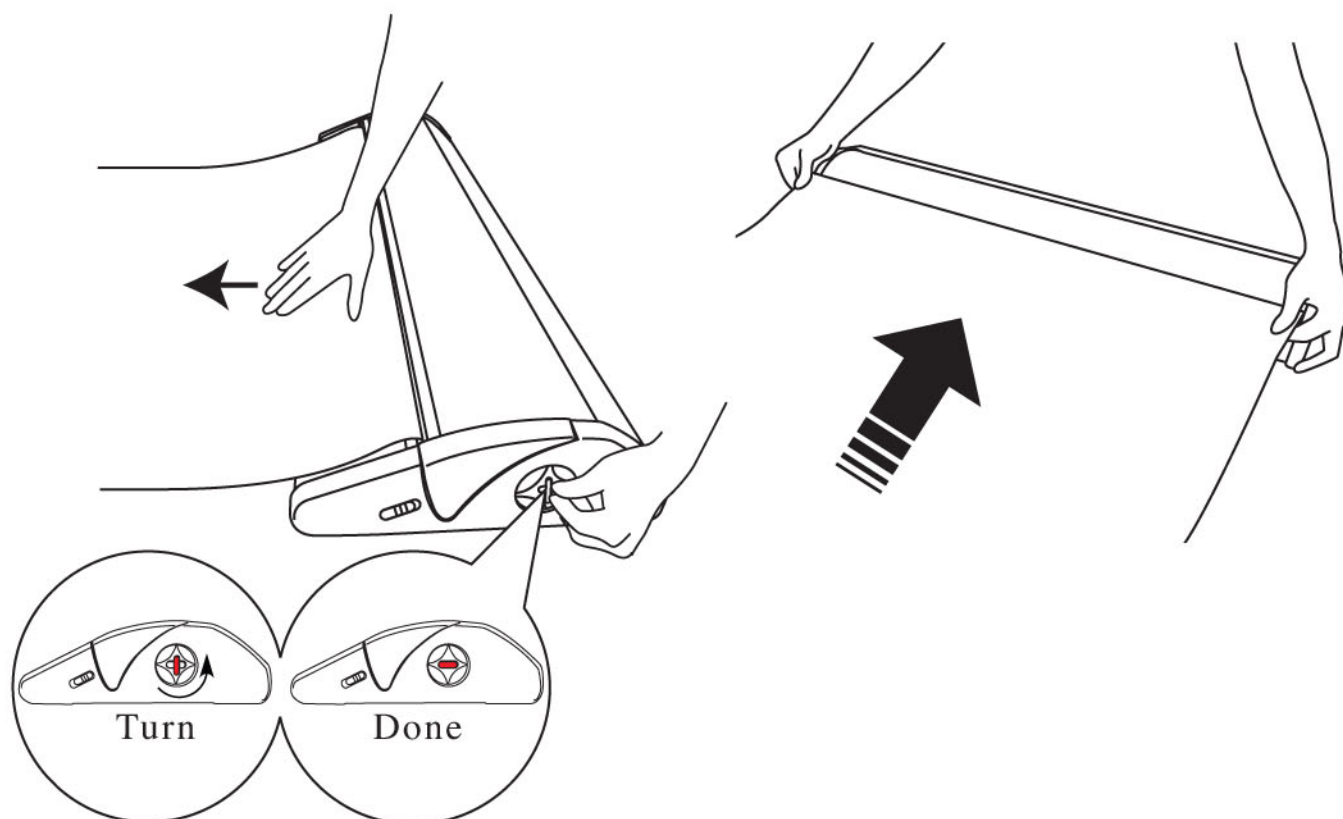

Adjusting Tension

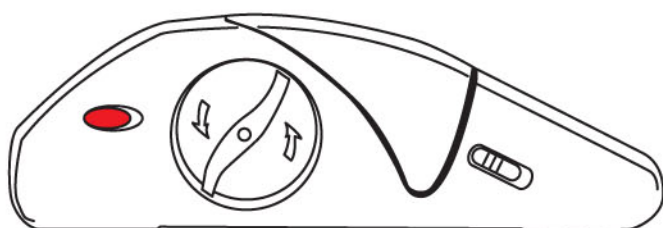

* Adding Tension

Turn the black tension device to put on additional tension.

* Releasing Tension

By pushing the red button forward, the tension on the spring would be released completely.

* Rebuilding Tension

To rebuild the tension, push the red button backward and turn the black tension device until the graphic retracts completely.

SET UP INSTRUCTION

Infinity
SPACE

3 - Parted Pole

1. Unfold the 3-parted pole.

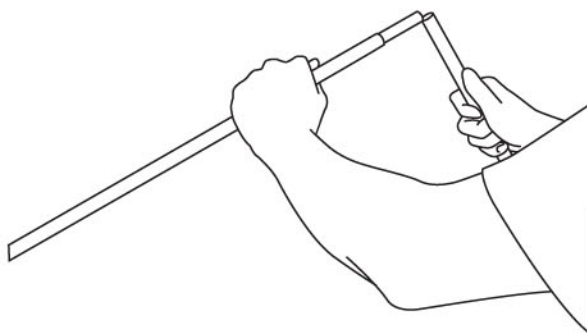
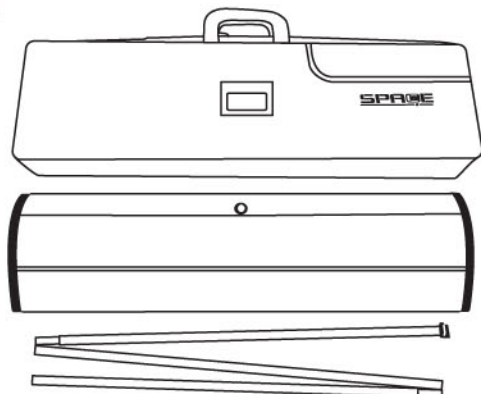

2. Insert the pole onto the cup of the base.

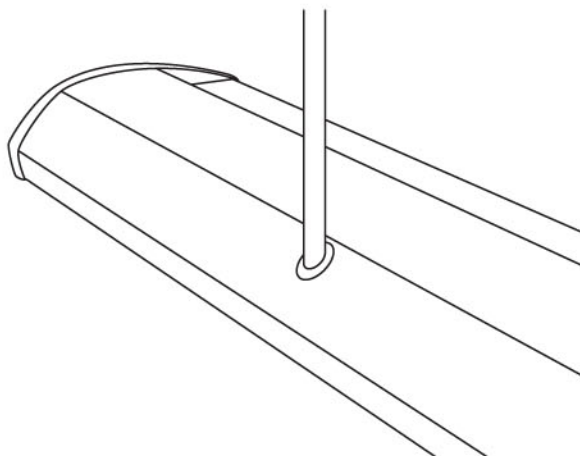

3. Pull up the graphic and position the plastic end tip of the pole into the profile.

